

Figure 2.

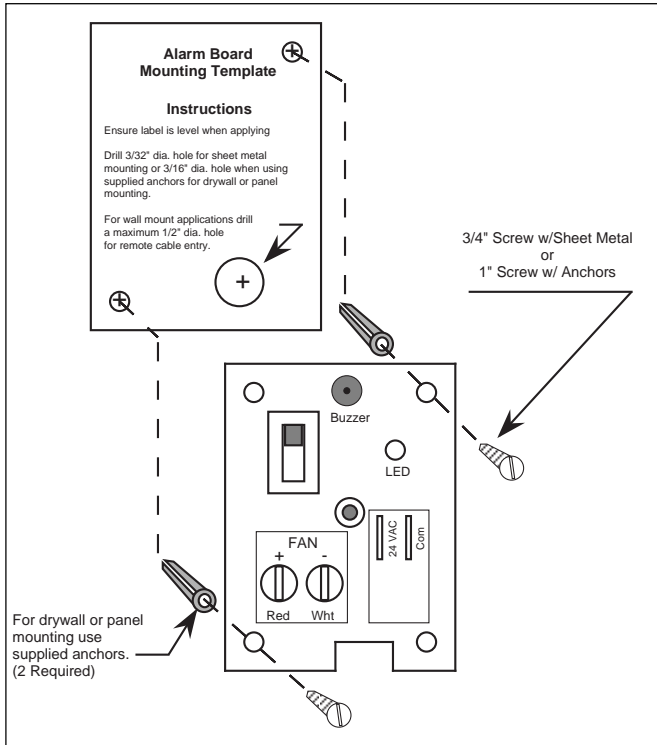

Figure 3.  
Lower Alarm Circuit Board Mounting

## LOWER ALARM CIRCUIT BOARD

The lower alarm circuit board comes equipped for mounting to the interior of the furnace. It may also be wired for remote wall mount applications using standard low voltage thermostat wire.

Provisions have been made for the low voltage wiring to be concealed on drywall and panel mount applications by entering from behind the bottom of the circuit board. (See mounting template for proper hole location.) On furnace or alcove mounting applications the wiring will enter through the bottom of the lower alarm board cover.

**NOTE:** For furnace mount applications the following lower alarm board locations are recommended.

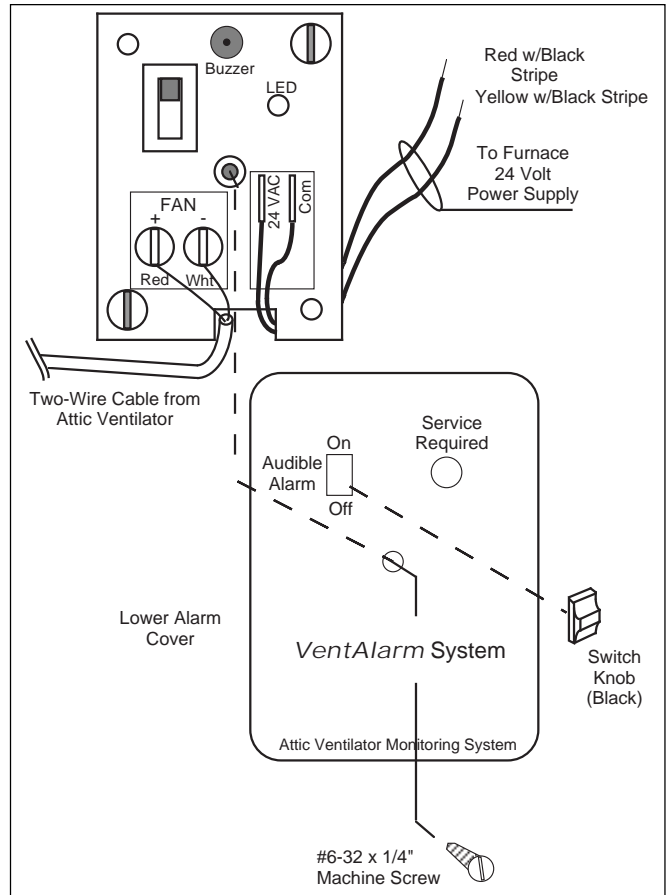

Figure 4. VentAlarm™ for VentilAire IV Ventilator

- For "MG", "MM", "MB", "MS", and "M1" Series furnaces it is recommended to locate the lower alarm board on the left interior side panel of the furnace, next to the thermostat low voltage wiring entrance just above the furnace control panel.
- For "E1" and "E2" Series furnaces it is recommended to locate the lower alarm board on the right interior side panel. The insulation has been removed for installation of an alarm mounting bracket, NORDYNE P/N-902933.
- Mounting of the lower alarm circuit board using the supplied template is recommended to ensure proper alignment of the holes. Drill the appropriate diameter holes for the application at the two designated locations shown. Drill 3/32" holes for sheet metal mounting or 3/16" holes for drywall or panel mounting (See Figure 3).
- 3/4" self drilling screws for sheet metal mounting or 1" screws and anchors for drywall and panel mounting have been provided in the Extra Parts Package.

## LOWER ALARM BOARD ELECTRICAL WIRING

### Fan Signal Wiring

For all furnace applications install the two-wire low voltage cable from the attic ventilator to the two terminals on the lower alarm circuit board marked "FAN" (See Figure 4).

## ELECTRIC, GAS AND OIL FURNACES

### 24 Volt Power Supply

Furnace mount applications will use the supplied Red w/ Black stripe and Yellow w/ Black stripe wires for connecting to the furnace 24 Volt power supply. See "LOW VOLTAGE CONNECTIONS" for your specific furnace application. For remote wall mount applications run standard two wire thermostat wire from the lower alarm board location to the furnace 24 Volt power supply. Use the two insulated crimp terminals supplied in the Extra Parts Package for mounting the cable to the lower alarm board.

## LOW VOLTAGE CONNECTIONS

### Gas Furnaces

#### MG/MM Series Sealed Combustion Gas Furnace

24 Volts is supplied using the Red (24V Hot) and Yellow (24V Com) wires in the 6-pin thermostat plug. The Yellow (24V Com) wire is marked with an Accessory label.

#### MB Series Sealed Combustion Gas Gun Furnace

24 Volts is supplied using the Red (24V Hot) and Yellow w/ Black stripe (24V Com) wires located on top of the furnace control panel. The Yellow w/ Black stripe (24V Com) wire is marked with an Accessory label.

#### M1G/M1M/M1S Series

24 Volts is supplied using the red (24V Hot) and Gray (24V Com) wires in the 6-pin thermostat plug.

### Oil Furnaces

### MS Series Sealed Combustion Oil Gun Furnace

24 Volts is supplied using an Optional Auxiliary transformer. Red w/ Black stripe (24V Hot) and Yellow w/ Black stripe (24V Com) wires are supplied separately for optional accessories. The Red w/ Black stripe and Yellow w/ Black stripe wires are marked with an Accessory label.

### M1S Series

24 Volts is supplied using the red (24V Hot) and Gray (24V Com) wires in the 6-pin thermostat plug.

### Electric Furnaces

For E1 and E2 Series interior furnace mounting order NORDYNE P/N-902933, Alarm Mounting Bracket.

#### E1 & E2 Series - Standard Unit.

24 Volts is supplied using the Red (24V Hot) and Black (24V Com) wires in the 6-pin thermostat plug.

Complete the installation by mounting the cover using the supplied #6-32 x 1/4" machine screw. Attach the Black switch knob provided with the alarm board. Ensure the switch is set to the Audible Alarm "ON" position when complete.

### Field Supplied Air Conditioning and Heat Pump Accessories

#### E1 & E2 Series with 2-Wire Relay Box.

24 Volts is supplied using the "Y" and "W" terminals on the two wire relay box.

**NOTE:** This termination on the 2-wire relay box does not follow standard low voltage connection practices.

#### E1EH & E2EH with 4 - 7 Wire Relay Box.

24 Volts is supplied using the "R" and "C" terminals on the four wire relay box.

**INSTALLER:**

**PLEASE LEAVE THESE INSTALLATION  
INSTRUCTIONS WITH THE HOMEOWNER.**