

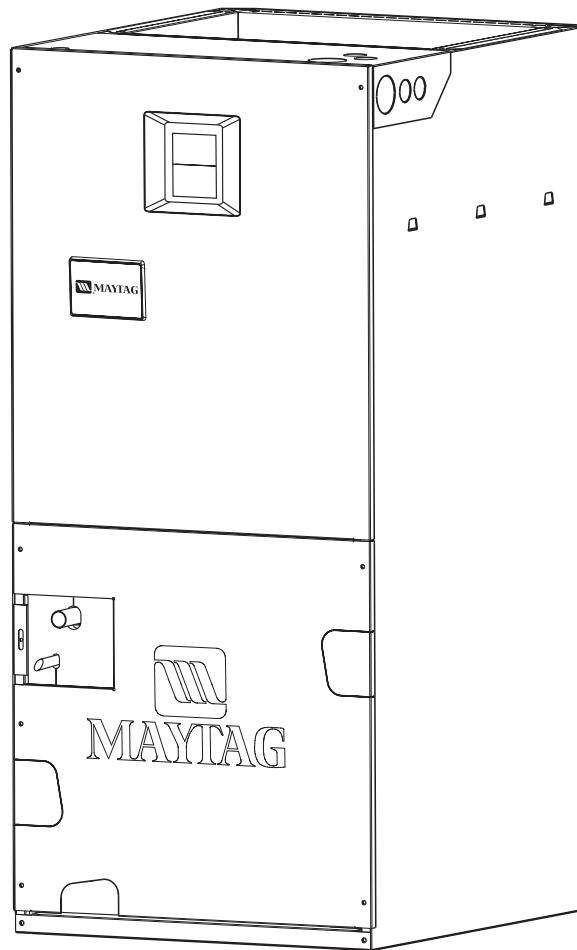

TECHNICAL SPECIFICATIONS

Model PAH1BM Series



M1010 Product Line

**Air Handler
12 Plus SEER Residential System**

- 10YEAR
WARRANTY
- WORRY-FREE
PERFORMANCE



The PAH1BM Series of air handlers, when combined with our heat pump or air conditioner, offers a full line of quality, split system heating and cooling equipment.

Features and Benefits

- **10 Year Limited Parts and Labor Warranty** - Proven to be a major benefit to the consumer.
- **Increased Efficiencies**-Air conditioning and heat pump efficiencies up to 14 SEER and 8.5 HSPF.
- **Quiet Blower Operation** - Extra quiet and smooth blower on and off cycles.
- **Multi-speed** - Gives flexibility of installation.
- **Multi-poised** - Can be used in horizontal, upflow, downflow and vertical applications.
- **Built in Filter Rack** - makes the air handler easy to service.
- **Plug-in Heater Kits** - Available in 5 kw through 20 kw (Not for use in 115 Volt units)
- **Breaker Accessibility** - Breaker accessible from the front of the unit when heater is applied.
- **Plastic Drain Pan** - Provides corrosion resistance.
- **Durable Cabinet** - Galvanized steel with a polyurethane finish. The finish will endure 950 hours of salt spray and resist corrosion 50% better than comparable units.
- **Circuit Board** - Incorporating Blower Delay Relay and Low Voltage Terminal Strip.
- **Ease-of-Service** - Plug-in wire connections and built-in filter rack makes the air handler easy to service.
- **No Fasteners on Sides or Back** - Smooth surfaces for installations.

SPECIFICATIONS

Model Number PAH1BM	024KA	030KA	030KB	036KB	042KB	048KB	060KC	062KC	066KC
Nominal Cooling Capacity - Btuh (1)	24,000	30,000	30,000	36,000	42,000	48,000	60,000	60,000	60,000
Refrigerant Flow Control (2)	.060 (.051)*	.063 (.067)*	.063	.067	.075	.080	.093	.085	.103
Maximum Available (3) Auxiliary Heat (kw)	14	14	20	20	20	20	20	20	20
Nominal Blower Size (D x W)	10 x 6	10 x 6	10 x 8	10 x 8	10 x 8	10 x 8	10 x 10	10 x 10	10 x 10
(H.P. - Speed - Type)	1/5-3-PSC	1/3-3-PSC	1/3-3-PSC	1/3-3-PSC	1/3-3-PSC	1/2-3-PSC	3/4-3-PSC	3/4-3-PSC	3/4-3-PSC
Rated External Static Pressure (in. W.C.)	.30	.35	.35	.35	.35	.40	.40	.40	.40
CFM @ Rated ESP	880	1150	1250	1250	1300	1450	1880	1920	1920
Filter Size (4)	12 x 20 x 1	12 x 20 x 1	18 x 20 x 1	18 x 20 x 1	18 x 20 x 1	18 x 20 x 1	20 x 20 x 1	20 x 20 x 1	20 x 20 x 1
Approximate Shipping Weight (lbs.)	75	85	105	105	110	140	145	150	155

(1) See current ARI Directory for certified combinations and ratings.

(2) Units are 10 SEER air conditioner ready as shipped.

(3) Heater kits not applicable to 115 Volt units.

(4) Filter is field supplied.

* Additional orifice shipped with unit

ACCESSORIES

Accessory Kit Description	Cabinet Size			Order Number
	A	B	C	
Downflow Adaptor Kit	X			917342
		X		917343A
			X	917344A
Single Circuit Adaptor Kit		X	X	913874
Variable Speed Kit		X		903764B
			X	903765B

**240V Single Phase Electric Heat Kits

KW	No. of Stages	Approved for Cabinet	Order Number	
			with Circuit Breaker(s)	w/o Circuit Breaker(s)
5	1	A, B, C	917367B	917366B
8	1	A, B, C	917370B	917368B
10	1	A, B, C	917374B	917372B
12	1	A, B, C	904198B	N/A
15	1	B, C	903959B	N/A
20	1	B, C	903960B	N/A

**Not for use with 115 Volt units.

IDENTIFICATION CODE

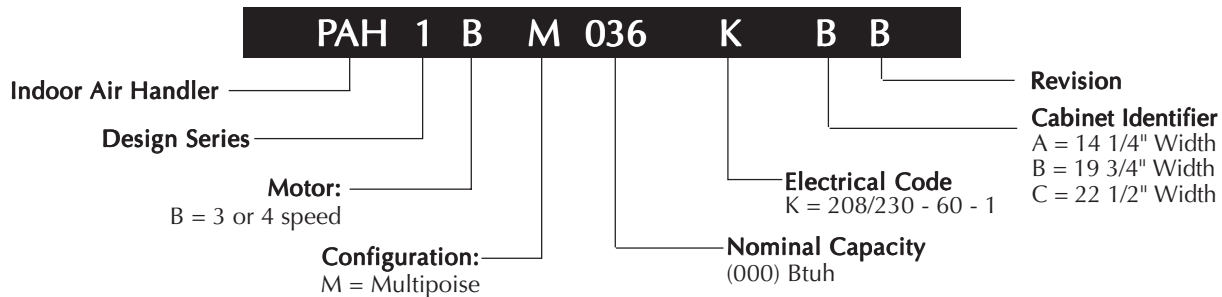

SYSTEM AIR FLOW DATA

Unit	HP	Speed	ESP ("H2O)	CFM Low	CFM Med	CFM High
024KA	1/5 HP 10 X 6	3	0.1	620	750	950
			0.2	580	730	930
			0.3	520	680	880
			0.4	460	630	830
			0.5	400	580	770
030KA	1/3 HP 10 X 6	3	0.1	860	1100	1250
			0.2	840	1090	1230
			0.3	800	1040	1170
			0.4	750	990	1120
			0.5	720	950	1070
030KB	1/3 HP 10 X 8	3	0.1	920	1230	1420
			0.2	890	1190	1380
			0.3	820	1120	1290
			0.4	760	1050	1210
			0.5	690	980	1130
036KB	1/3 HP 10 X 8	3	0.1	920	1230	1420
			0.2	890	1190	1380
			0.3	820	1120	1290
			0.4	760	1050	1210
			0.5	690	980	1130
042KB	1/3 HP 10 X 8	3	0.1	920	1230	1420
			0.2	890	1190	1380
			0.3	820	1120	1300
			0.4	760	1090	1210
			0.5	690	980	1130
048KB	1/2 HP 10 X 8	3	0.1	1510	1620	1690
			0.2	1470	1580	1650
			0.3	1390	1490	1510
			0.4	1320	1410	1450
			0.5	1250	1340	1380
060KC	3/4 HP 10 X 10	3	0.1	1840	1990	2090
			0.2	1780	1930	2060
			0.3	1710	1860	1980
			0.4	1640	1790	1880
			0.5	1570	1710	1810
062KC	3/4 HP 10 X 10	3	0.1	1880	2030	2130
			0.2	1820	1970	2100
			0.3	1750	1900	2020
			0.4	1680	1830	1920
			0.5	1610	1750	1850
066KC	3/4 HP 10 X 10	3	0.1	1880	2030	2130
			0.2	1820	1970	2100
			0.3	1750	1900	2020
			0.4	1680	1830	1920
			0.5	1610	1750	1850

Notes:

- 1) Airflow is shown in cfm, +/- 5%.
- 2) External static pressure is shown in inches w.c.
- 3) All airflows are measured without filter and with dry coil. For filter velocity of 300 ft./min. subtract .08" external static pressure. For wet coil, subtract .1" external static pressure.
- 4) See unit nameplate or installation instructions for maximum recommended external static pressure.

ELECTRICAL DATA

Model Number H4HK			Standard Air Handler			Variable Speed Air Handler								
			Min. Circuit Ampacity			Max. Over-Current Protection			Min. Circuit Ampacity			Max. Over-Current Protection		
			Circuit A	Circuit B	Single Circuit	Circuit A	Circuit B	Single Circuit	Circuit A	Circuit B	Single Circuit	Circuit A	Circuit B	Single Circuit
005H-XXB	240	4.8	-	-	30.0	-	-	30	-	-	34.8	-	-	40
008H-XXB	240	7.5	-	-	44.1	-	-	50	-	-	47.8	-	-	50
010H-XXB	240	9.6	-	-	55.0	-	-	60	-	-	58.8	-	-	60
012H-XXB	240	11.6	35.2	30.2	65.4	40	40	70	39.0	30.2	69.2	40	40	70
015H-XXB	240	14.4	55.0	25.0	80.0	60	30	90	59.3	25.0	83.8	60	30	90
020H-XXB	240	19.2	55.0	50.0	105.0	60	50	125	59.3	50.0	108.8	60	50	125
005H-XXB	208	3.6	-	-	26.6	-	-	30	-	-	30.9	-	-	40
008H-XXB	208	5.6	-	-	38.8	-	-	40	-	-	43.1	-	-	50
010H-XXB	208	7.2	-	-	48.3	-	-	50	-	-	52.5	-	-	60
012H-XXB	208	8.8	31.4	26.4	57.9	40	30	60	35.2	26.4	61.6	40	30	70
015H-XXB	208	10.8	48.3	21.6	69.7	50	30	70	52.5	21.6	74.2	60	30	80
020H-XXB	208	14.4	48.3	43.3	91.5	50	50	100	52.5	43.3	95.8	60	50	100

IDENTIFICATION CODE

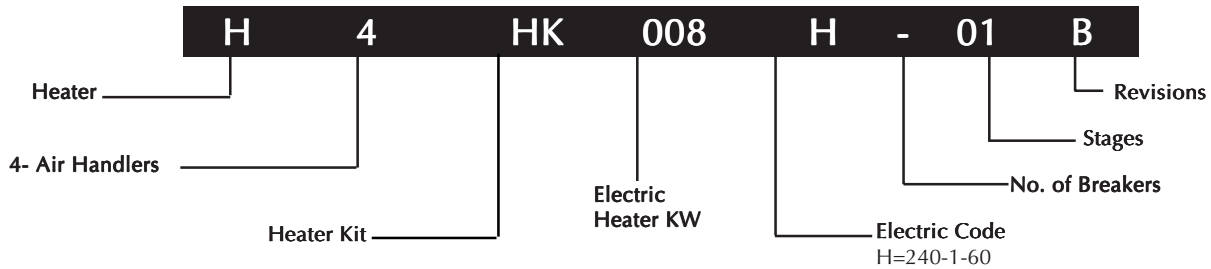

DIMENSIONS

Model Number PAH1BM	H	W	A	Refrigerant Connections		Filter Size	Supply Air Duct Dimension
				Suction Dia.	Liquid Dia.		
024KA	42	14 1/4	12 3/4	3/4	3/8	12 x 20 x 1	12 7/8 x 12 3/4
030KA	42	14 1/4	12 3/4	3/4	3/8	12 x 20 x 1	12 7/8 x 12 3/4
030KB	43 1/2	19 3/4	18 1/4	3/4	3/8	18 x 20 x 1	12 7/8 x 18 1/4
036KB	43 1/2	19 3/4	18 1/4	3/4	3/8	18 x 20 x 1	12 7/8 x 18 1/4
042KB	43 1/2	19 3/4	18 1/4	3/4	3/8	18 x 20 x 1	12 7/8 x 18 1/4
048KB	43 1/2	19 3/4	18 1/4	3/4	3/8	18 x 20 x 1	12 7/8 x 18 1/4
060KC	43 1/2	22 1/2	21	7/8	3/8	20 x 20 x 1	12 7/8 x 21
062KC	53 1/2	22 1/2	21	7/8	3/8	20 x 20 x 1	12 7/8 x 21
066KC	53 1/2	22 1/2	21	7/8	3/8	20 x 20 x 1	12 7/8 x 21

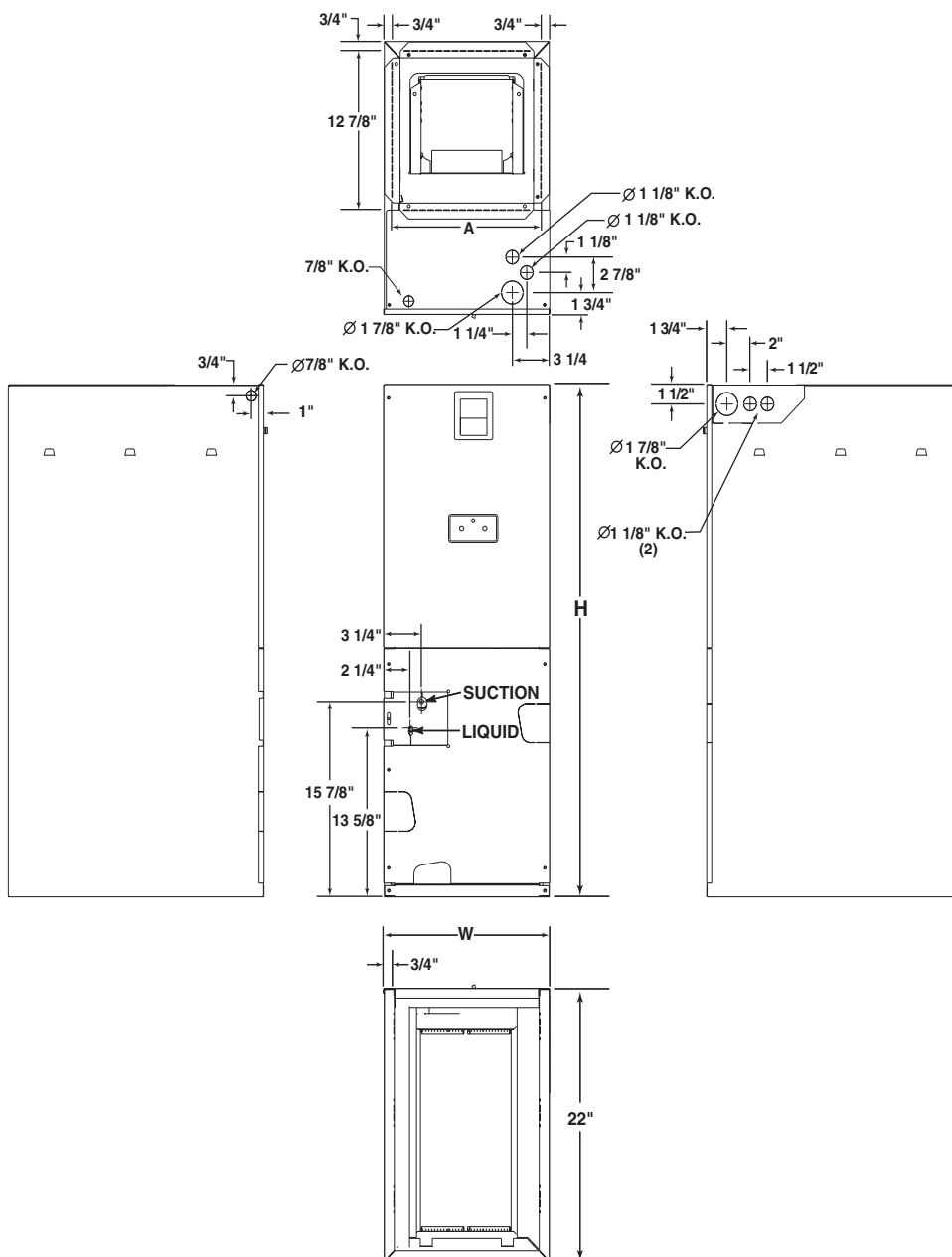



Before purchasing this appliance, read important energy cost and efficiency information available from your retailer. Specifications and illustrations subject to change without notice and without incurring obligations.

Maytag is a registered trademark of the Maytag Corporation and is used under license to NORDYNE Inc.

284B-0605 (Replaces 284B-0604)

Printed in U.S.A. (06/05)